

Nut

LOCKNUT PG9 NICKEL BRASS



Nut, nickel-plated brass

Dimensions

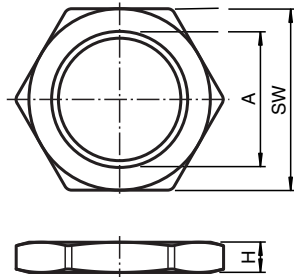

Technical Data

Mechanical specifications	
Material	brass, nickel-plated
Dimensions	A = PG9 H = 2.8 mm SW = 18 mm

Release date: 2020-03-20 Date of issue: 2020-06-29 Filename: 002033_eng.pdf