

Inductive slot sensor

SJ10-E

- 10 mm slot width
- 3-wire DC



Dimensions

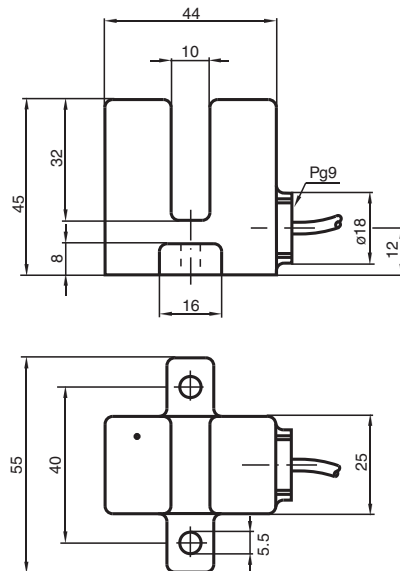

Technical Data

General specifications

Switching function	Normally open (NO)
Output type	NPN
Slot width	10 mm
Depth of immersion (lateral)	13.5 ... 16.5 mm
Output polarity	DC
Output type	3-wire

Nominal ratings

Operating voltage	U_B	10 ... 30 V DC
Switching frequency	f	0 ... 1000 Hz
Hysteresis	H	typ. 5%
Reverse polarity protection		reverse polarity protected
Short-circuit protection		pulsing
Voltage drop	U_d	≤ 3 V

Release date: 2024-05-28 Date of issue: 2024-06-05 Filename: 015050_eng.pdf

Technical Data

Operating current	I_L	0 ... 200 mA
No-load supply current	I_0	≤ 15 mA
Compliance with standards and directives		
Standard conformity		
Standards		EN IEC 60947-5-2
Approvals and certificates		
UL approval		cULus Listed, General Purpose
CCC approval		CCC approval / marking not required for products rated ≤36 V
Ambient conditions		
Ambient temperature		-25 ... 70 °C (-13 ... 158 °F)
Mechanical specifications		
Connection type		cable
Housing material		PBT
Degree of protection		IP67
Cable		
Wire end ferrules		yes
Cable diameter		6.4 mm ± 0.2 mm
Bending radius		> 10 x cable diameter
Material		PVC
Color		Gray
Number of cores		3
Core cross section		0.75 mm ²
Length	L	2 m
Mass		221 g
Tightening torque, fastening screws		3 Nm
Dimensions		
Height		45 mm
Width		55 mm
Length		44 mm

Connection

