

# Inductive sensor

## NJ2-12GM50-WO



- 2 mm flush
- 2-wire AC



### Dimensions

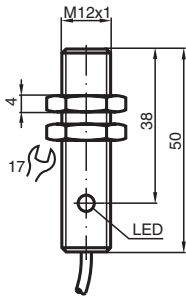

### Technical Data

General specifications		
Switching function		Normally closed (NC)
Output type		Two-wire
Rated operating distance	$s_n$	2 mm
Installation		flush
Output polarity		AC
Assured operating distance	$s_a$	0 ... 1.62 mm
Reduction factor $r_{Al}$		0.1
Reduction factor $r_{Cu}$		0.1
Reduction factor $r_{304}$		0.6
Output type		2-wire
Nominal ratings		
Operating voltage	$U_B$	20 ... 253 V
Switching frequency	$f$	0 ... 20 Hz
Reverse polarity protection		reverse polarity tolerant
Voltage drop	$U_d$	typ. 4 V at 15 ... 200 mA typ. 6.5 V at 5 mA

Release date: 2025-06-04 Date of issue: 2025-06-04 Filename: 026574\_eng.pdf

## Technical Data

Momentary current (20 ms, 0.1 Hz)		0 ... 1200 mA
Operating current	$I_L$	5 ... 200 mA
Off-state current	$I_r$	typ. 0.7 mA
Time delay before availability	$t_v$	≤ 30 ms
Switching state indicator		LED, yellow
<b>Compliance with standards and directives</b>		
Standard conformity		
Standards		EN IEC 60947-5-2
<b>Approvals and certificates</b>		
UL approval		cULus Listed, General Purpose
CSA approval		cCSAus Listed, General Purpose
CCC approval		Certified by China Compulsory Certification (CCC)
<b>Ambient conditions</b>		
Ambient temperature		-25 ... 70 °C (-13 ... 158 °F)
<b>Mechanical specifications</b>		
Connection type		cable
Housing material		Stainless steel 1.4305 / AISI 303
Sensing face		PBT
Degree of protection		IP67
<b>Cable</b>		
Wire end ferrules		yes
Cable diameter		4.6 mm ± 0.2 mm
Bending radius		> 10 x cable diameter
Material		PVC
Color		grey
Number of cores		3
Core cross section		0.34 mm <sup>2</sup>
Length	L	2 m
<b>Dimensions</b>		
Length		50 mm
Diameter		12 mm
Note		1) In the temperature range below 0 °C, permissible operating voltage $U_b$ 80...253 V Safety fuse ≤ 2 A (quick-blow) according to IEC 60127-2 Sheet 1 Recommendation: after a short circuit, check that the device is functioning correctly.
<b>General information</b>		
Scope of delivery		2 self locking nuts in scope of delivery

## Connection

