

Inductive ring sensor

RC10-14-N0-Y95902

- 10 mm inside diameter
- Comfort series



Dimensions

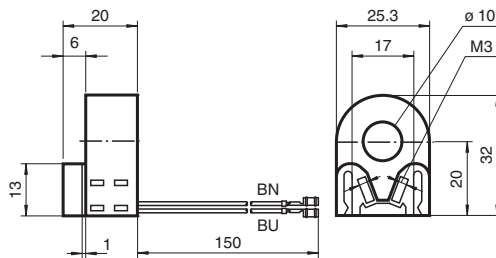

Technical Data

General specifications

Switching function	Normally closed (NC)
Output type	NAMUR
Inside diameter	10 mm
Measuring cone	4 mm, 1.4305 / AISI 303
Output type	2-wire

Nominal ratings

Nominal voltage	U_o	8 V
Operating voltage	U_B	5 ... 25 V
Switching frequency	f	0 ... 2000 Hz
Current consumption		
Measuring plate not detected		min. 3 mA at maximum permissible ambient temperature, the current consumption can drop to 1.6 mA
Measuring plate detected		≤ 1 mA

Functional safety related parameters

MTTF _d	6150 a
Mission Time (T _M)	20 a
Diagnostic Coverage (DC)	0 %

Compliance with standards and directives

Standard conformity	
NAMUR	EN 60947-5-6:2000 IEC 60947-5-6:1999
Standards	EN IEC 60947-5-2

Approvals and certificates

ATEX approval	
Equipment protection level Gb	PTB 99 ATEX 2128 X
UL approval	cULus Listed, General Purpose

Ambient conditions

Release date: 2024-05-27 Date of issue: 2024-05-28 Filename: 095902_eng.pdf

Technical Data

Ambient temperature	-20 ... 65 °C (-4 ... 149 °F)
Storage temperature	-40 ... 100 °C (-40 ... 212 °F)
Mechanical specifications	
Connection type	cable PVC , 150 mm Crimp terminal sockets 60888-3, AMP
Core cross section	0.14 mm ²
Housing material	PBT
Degree of protection	IP67
Mass	18 g
Dimensions	
Height	32.5 mm
Width	25 mm
Length	20 mm
General information	
Use in the hazardous area	see instruction manuals

Connection

