

Nut

LOCKNUT M16 NICKEL BRASS



Nut, nickel-plated brass

Dimensions

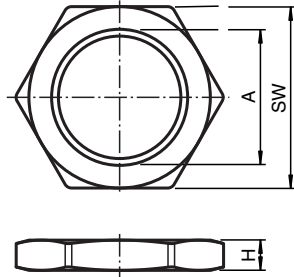

Technical Data

Mechanical specifications	
Material	brass, nickel-plated
Dimensions	
Height	5 mm
Width across flats	SW 24
Thread size	A = M16 x 1.5

Release date: 2023-11-30 Date of issue: 2023-11-30 Filename: 107579_eng.pdf