



# Inductive sensor NBN4-F29-E3-5M

■ Basic series



## Dimensions

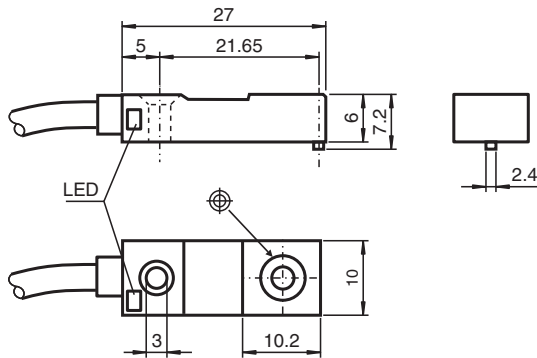

## Technical Data

### General specifications

|                            |       |                      |
|----------------------------|-------|----------------------|
| Switching function         |       | Normally closed (NC) |
| Output type                |       | PNP                  |
| Rated operating distance   | $s_n$ | 4 mm                 |
| Installation               |       | non-flush            |
| Output polarity            |       | DC                   |
| Assured operating distance | $s_a$ | 0 ... 3.24 mm        |
| Reduction factor $r_{Al}$  |       | 0.4                  |
| Reduction factor $r_{Cu}$  |       | 0.3                  |
| Reduction factor $r_{304}$ |       | 0.7                  |
| Output type                |       | 3-wire               |

### Nominal ratings

|                             |       |                                        |
|-----------------------------|-------|----------------------------------------|
| Operating voltage           | $U_B$ | 4.75 ... 30 V DC                       |
| Switching frequency         | $f$   | 0 ... 1000 Hz                          |
| Hysteresis                  | $H$   | typ. 5 %                               |
| Reverse polarity protection |       | reverse polarity protected             |
| Short-circuit protection    |       | pulsing                                |
| Voltage drop                | $U_d$ | $\leq 3$ V                             |
| Operating current           | $I_L$ | 0 ... 100 mA                           |
| Off-state current           | $I_r$ | 0 ... 0.5 mA typ. 0.1 $\mu$ A at 25 °C |

Release date: 2025-02-27 Date of issue: 2025-02-28 Filename: 116288\_eng.pdf

## Technical Data

|                                                 |       |                                                                            |
|-------------------------------------------------|-------|----------------------------------------------------------------------------|
| No-load supply current                          | $I_0$ | $\leq 10 \text{ mA}$                                                       |
| Time delay before availability                  | $t_v$ | $\leq 5 \text{ ms}$                                                        |
| Switching state indicator                       |       | LED, yellow                                                                |
| <b>Functional safety related parameters</b>     |       |                                                                            |
| MTTF <sub>d</sub>                               |       | 2133 a                                                                     |
| Mission Time (T <sub>M</sub> )                  |       | 20 a                                                                       |
| Diagnostic Coverage (DC)                        |       | 0 %                                                                        |
| <b>Compliance with standards and directives</b> |       |                                                                            |
| Standard conformity                             |       |                                                                            |
| Standards                                       |       | EN IEC 60947-5-2                                                           |
| <b>Approvals and certificates</b>               |       |                                                                            |
| UL approval                                     |       | cULus Listed, General Purpose                                              |
| CCC approval                                    |       | CCC approval / marking not required for products rated $\leq 36 \text{ V}$ |
| <b>Ambient conditions</b>                       |       |                                                                            |
| Ambient temperature                             |       | -25 ... 70 °C (-13 ... 158 °F)                                             |
| Storage temperature                             |       | -40 ... 85 °C (-40 ... 185 °F)                                             |
| <b>Mechanical specifications</b>                |       |                                                                            |
| Connection type                                 |       | cable                                                                      |
| Housing material                                |       | PPS                                                                        |
| Sensing face                                    |       | PPS                                                                        |
| Degree of protection                            |       | IP67                                                                       |
| <b>Cable</b>                                    |       |                                                                            |
| Wire end ferrules                               |       | yes                                                                        |
| Cable diameter                                  |       | 3.5 mm $\pm$ 0.2 mm                                                        |
| Bending radius                                  |       | > 10 x cable diameter                                                      |
| Material                                        |       | PVC                                                                        |
| Color                                           |       | grey                                                                       |
| Number of cores                                 |       | 3                                                                          |
| Core cross section                              |       | 0.14 mm <sup>2</sup>                                                       |
| Length                                          | L     | 5 m                                                                        |
| <b>Dimensions</b>                               |       |                                                                            |
| Height                                          |       | 6 mm                                                                       |
| Width                                           |       | 10 mm                                                                      |
| Length                                          |       | 27 mm                                                                      |

## Connection Assignment

