

# Inductive sensor

## NCN2-8GM40-Z0

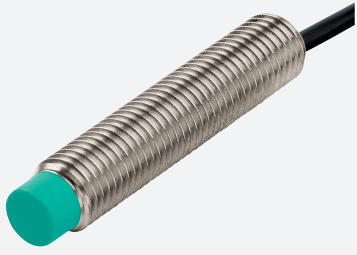

- 2 mm non-flush
- 2-wire DC



### Dimensions

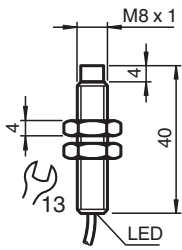

### Technical Data

| General specifications      |       |                           |
|-----------------------------|-------|---------------------------|
| Switching function          |       | Normally open (NO)        |
| Output type                 |       | Two-wire                  |
| Rated operating distance    | $s_n$ | 2 mm                      |
| Installation                |       | non-flush                 |
| Output polarity             |       | DC                        |
| Assured operating distance  | $s_a$ | 0 ... 1.62 mm             |
| Actual operating distance   | $s_r$ | 1.8 ... 2.2 mm typ.       |
| Reduction factor $r_{Al}$   |       | 0.4                       |
| Reduction factor $r_{Cu}$   |       | 0.39                      |
| Reduction factor $r_{304}$  |       | 0.75                      |
| Output type                 |       | 2-wire                    |
| Nominal ratings             |       |                           |
| Operating voltage           | $U_B$ | 5 ... 60 V                |
| Switching frequency         | $f$   | 0 ... 1200 Hz             |
| Hysteresis                  | $H$   | 1 ... 10 % typ. 5 %       |
| Reverse polarity protection |       | reverse polarity tolerant |

Release date: 2025-06-06 Date of issue: 2025-06-06 Filename: 126096\_eng.pdf

## Technical Data

|   |       |   |
|---|-------|---|
| Short-circuit protection                        |       | pulsing   |
| Voltage drop                                    | $U_d$ | $\leq 5 \text{ V}$                                |
| Operating current                               | $I_L$ | 2 ... 100 mA                                      |
| Lowest operating current                        | $I_m$ | 2 mA  |
| Off-state current                               | $I_r$ | 0 ... 0.5 mA typ.                                 |
| Switching state indicator                       |       | LED, yellow                                       |
| <b>Compliance with standards and directives</b> |       |   |
| Standard conformity                             |       |   |
| Standards                                       |       | EN IEC 60947-5-2                                  |
| <b>Approvals and certificates</b>               |       |   |
| UL approval                                     |       | cULus Listed, General Purpose                     |
| CCC approval                                    |       | Certified by China Compulsory Certification (CCC) |
| <b>Ambient conditions</b>                       |       |   |
| Ambient temperature                             |       | -25 ... 70 °C (-13 ... 158 °F)                    |
| <b>Mechanical specifications</b>                |       |   |
| Connection type                                 |       | cable   |
| Housing material                                |       | Stainless steel 1.4305 / AISI 303                 |
| Sensing face                                    |       | PBT   |
| Degree of protection                            |       | IP67  |
| <b>Cable</b>                                    |       |   |
| Wire end ferrules                               |       | yes   |
| Cable diameter                                  |       | 2.8 mm $\pm$ 0.1 mm                               |
| Bending radius                                  |       | > 10 x cable diameter                             |
| Material  |       | PUR   |
| Color   |       | black   |
| Number of cores                                 |       | 2   |
| Core cross section                              |       | 0.14 mm <sup>2</sup>                              |
| Length  | L     | 2 m   |
| <b>Dimensions</b>                               |       |   |
| Length  |       | 40 mm   |
| Diameter  |       | 8 mm  |

## Connection

