

# Stop screw

## AS 08/40

- Safely sets the mechanical end stop position



Stop screw for series F2 sensors

### Dimensions

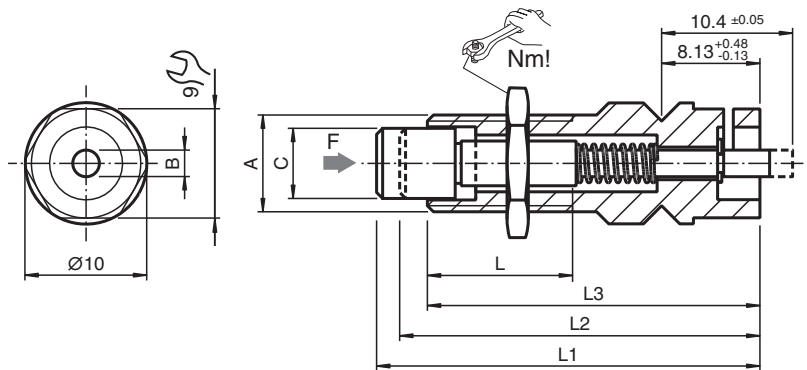

### Technical Data

#### Mechanical specifications

Operating force	min. 1.5 N max. 2000 N
Material	Steel 1.1191 / AISI 1045 (C45)
Dimensions	
A	M8 x 1
B	2.2 mm
C	5.8 mm
L	40 mm
L1	56.9 mm
L2	55 mm
L3	52.5 mm
Tightening torque	≤ 8 Nm
General information	
Note	If necessary, properly secure the lock nut
Scope of delivery	Stop screw Counter nut

Release date: 2025-02-25 Date of issue: 2025-02-25 Filename: 189303\_eng.pdf