

Nut

LOCKNUT M8 NICKEL BRASS



Nut, nickel-plated brass

Dimensions

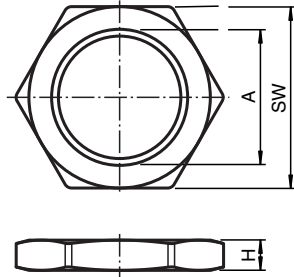

Technical Data

Mechanical specifications	
Material	brass, nickel-plated
Dimensions	
Height	2.8 mm
Width across flats	SW 10
Thread size	A = M8 x 1.25

Release date: 2023-11-30 Date of issue: 2023-11-30 Filename: 227525_eng.pdf