

Reflector REF-H33

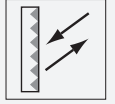

- M3 metal threaded insert

Reflector with screw fixing

Dimensions

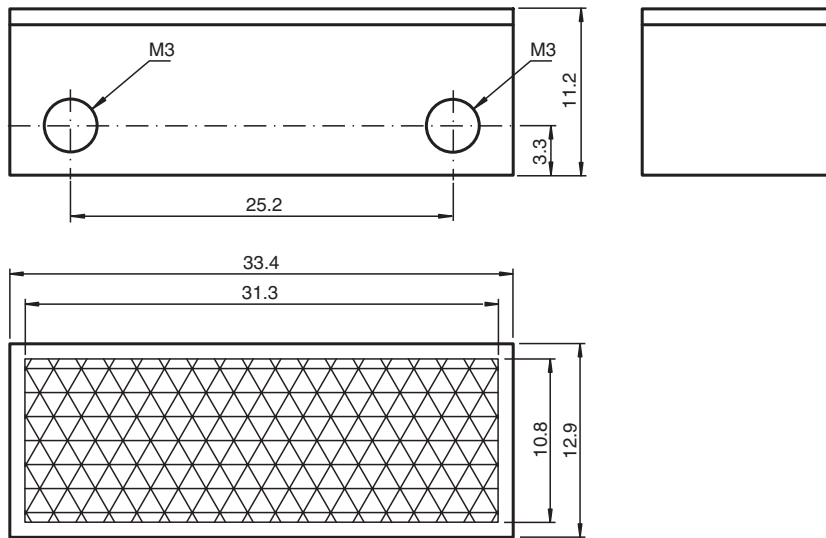

Technical Data

General specifications

Construction type rectangular

Ambient conditions

Ambient temperature -30 ... 65 °C (-22 ... 149 °F)







Mechanical specifications

Material PMMA/ABS

Dimensions 33.3 mm x 12.8 mm x 11 mm

Mounting M3 metal threaded insert

Accessories

	OMH-ML100-09	Mounting aid for round steel ø 12 mm or sheet 1.5 mm ... 3 mm
	OMH-10	Mounting aid for ML100 series
	OMH-ML100-01	Mounting aid for ML100 series, mounting bracket
	OMH-ML100-03	Mounting aid for round steel ø 12 mm or sheet 1.5 mm ... 3 mm
	OMH-ML100-04	Mounting aid for ML100 series, mounting bracket
	OMH-ML100-05	Mounting aid for ML100 series, mounting bracket