

# End cap set for DoorScan® sensor profile

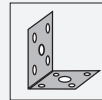

## DoorScan End Caps

- End caps for DoorScan® sensing strip

End cap set for DoorScan® sensor profile

### Dimensions

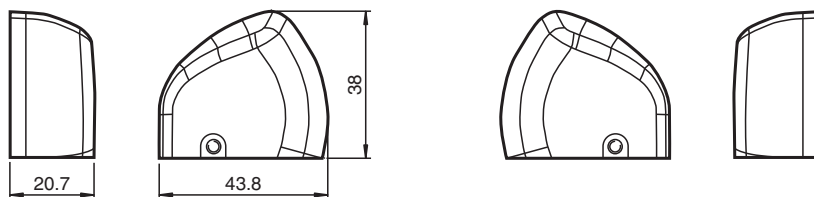

### Technical Data

#### Ambient conditions

Ambient temperature -50 ... 150 °C (-58 ... 302 °F)

#### Mechanical specifications

Material Polyamide PA 66 black

Mass approx. 16 g

#### General information

Scope of delivery 2 units (1x each right and left) , 2 cross head screws, 3x16 mm

#### Suitable series

Series DoorScan®

Release date: 2020-09-10 Date of issue: 2020-10-08 Filename: 247290\_eng.pdf