

Accessories Safety

OMH-SLCT-200

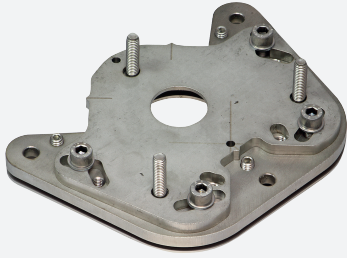

- Rotation of the SLCT-M-01 inclined mirror around the physically preferred rotational axis
- Vertical adjustment decoupled from rotation
- Mounting on ground anchors
- Lead-away of lines in floor via hole for NW29 coupling nut and corrugated hose
- Base plate to compensate for uneven ground, particularly for brittle surfaces
- Only approx. 20 mm in height from bottom edge of base plate to top edge of ground plate

Floor mount

Dimensions

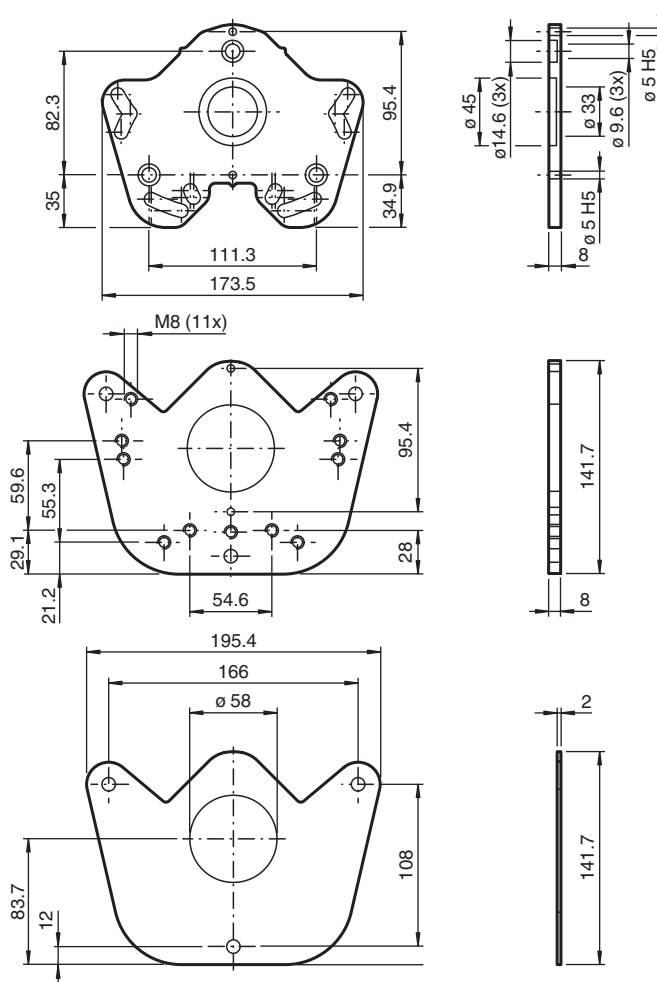

Technical Data

General specifications

Setting angle	± 5 °
Tilting angle	± 2.5 °

Release date: 2020-11-09 Date of issue: 2020-11-09 Filename: 251622_eng.pdf

Technical Data

Ambient conditions	
Ambient temperature	-40 ... 80 °C (-40 ... 176 °F)
Storage temperature	-40 ... 80 °C (-40 ... 176 °F)
Relative humidity	80 % , noncondensing
Mechanical specifications	
Material	
Housing	Stainless steel
Mounting screw	Steel bronzed
Mass	approx. 2.3 kg
Note	Hole for NW29 corrugated hose Ø33 mm
General information	
Scope of delivery	Base plate, intermediate plate, ground plate, drilling plan Mounting accessories M8 ground anchor not included with delivery
Suitable series	
Safety Series	SLCT / SLCS

Mounting

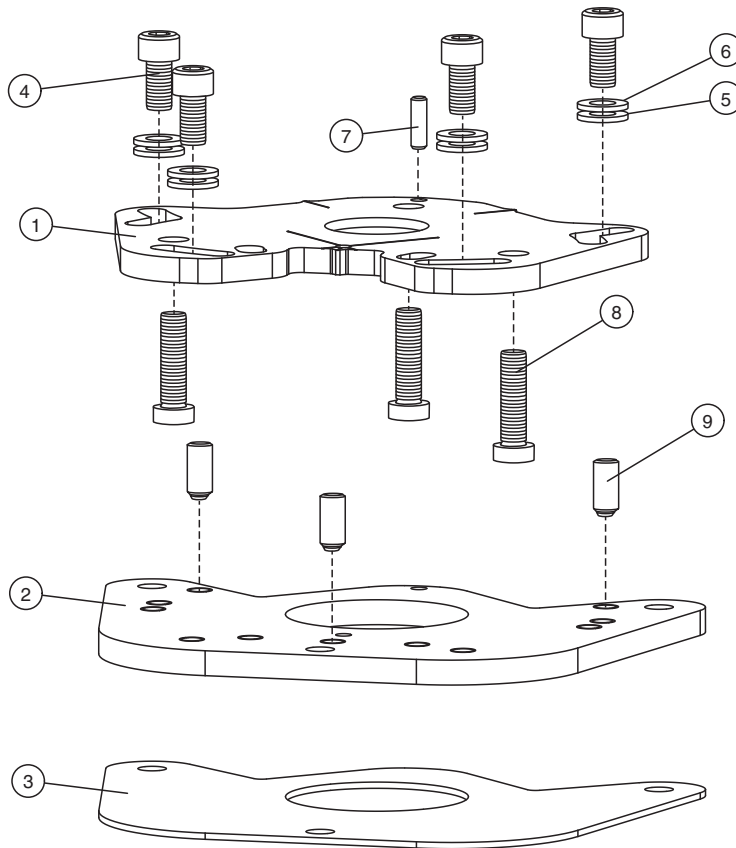









1	Base plate	4	Socket cap screw M8 x 16	7	Cylindrical pin 5m6 x 16
2	Intermediate plate	5	Washer	8	Socket cap screw M8 x 30
3	Ground plate	6	Lock washer	9	Headless screw M8 x 16

Accessories

	OMH-SLCT-100-1200	Mounting base for floor mounting and cover plate
---	--------------------------	--

Release date: 2020-11-09 Date of issue: 2020-11-09 Filename: 251622_eng.pdf

Accessories

	OMH-SLCT-100-1500	Mounting base for floor mounting and cover plate
	OMH-SLCT-100-2100	Mounting base for floor mounting and cover plate
	OMH-SLCT-100-2500	Mounting base for floor mounting and cover plate
	OMH-SLCT-110-1200	Mounting base for floor mounting with rear panel and cover plate
	OMH-SLCT-110-1500	Mounting base for floor mounting with rear panel and cover plate
	OMH-SLCT-110-2100	Mounting base for floor mounting with rear panel and cover plate
	SLCT-M-01-1200	Inclined mirror for stable 90° deflection with cover plate
	SLCT-M-01-1500	Inclined mirror for stable 90° deflection with cover plate
	SLCT-M-01-2100	Inclined mirror for stable 90° deflection with cover plate

Accessories

Other suitable accessories can be found at www.pepperl-fuchs.com