

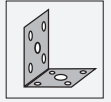

Mounting aid OMH-SLCT-12-500

- Can be attached to groove in two directions
- Rapid installation



Mounting bracket, muting arm with round rod $d=12$ mm

Dimensions

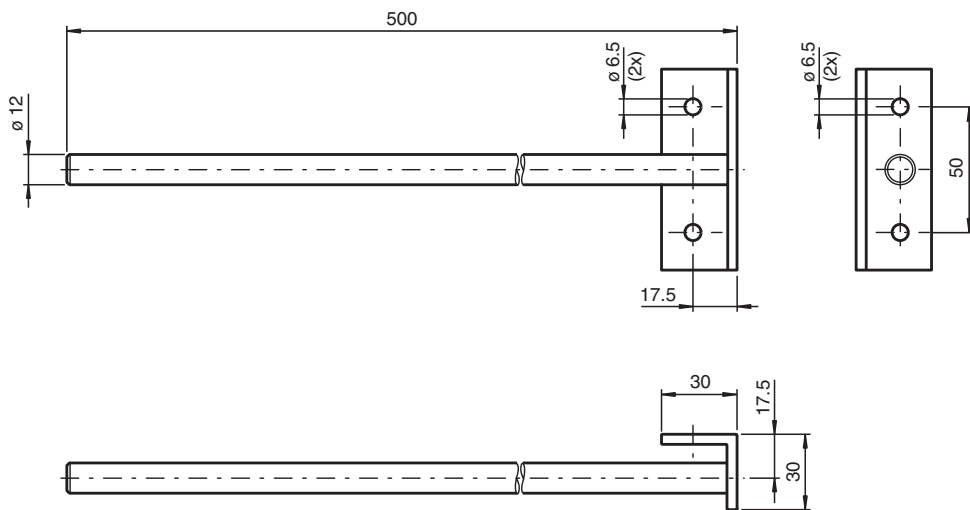

Technical Data

Mechanical specifications

Material	Aluminum
Mass	approx. 203 g

Technical Data

Dimensions	Length: 500 mm
General information	
Scope of delivery	Round rod with angle ; 2 t-slides 8 mm; Fixing screws , SW5 Allen wrench , Slotted plate
Suitable series	
Safety Series	SLCT / SLCS

Mounting

Each package comes with a slotted plate.

To prevent the t-slides from clipping into the upper hole, cover the hole with the slotted plate.

Then slide the t-slides into the guide.

