

# Combined sensor MotionScan

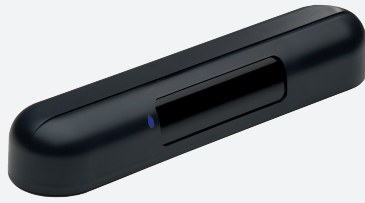

- Combined sensor for opening and securing automatic sliding doors
- Radar opening impulse
- Closing edge safety mechanism with diffuse sensor
- Safety mechanism in accordance with EN 16005
- Extra-large, adjustable protection field in front of the door
- Door learn function

Combination sensor for opening and protection

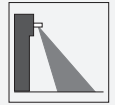

## Function

The two-in-one MotionScan sensor for opening and securing automatic sliding doors allows doors to be opened in a timely manner thanks to its large radar detection field. A large, adjustable infrared protection field ensures maximum safety. The special Door Learn function enables a protection field to be defined both in front of and behind the door. The MotionScan works reliably with a wide range of floor surfaces. It is incredibly easy to install and operate with single-button operation and multicolor LED display.

## Dimensions

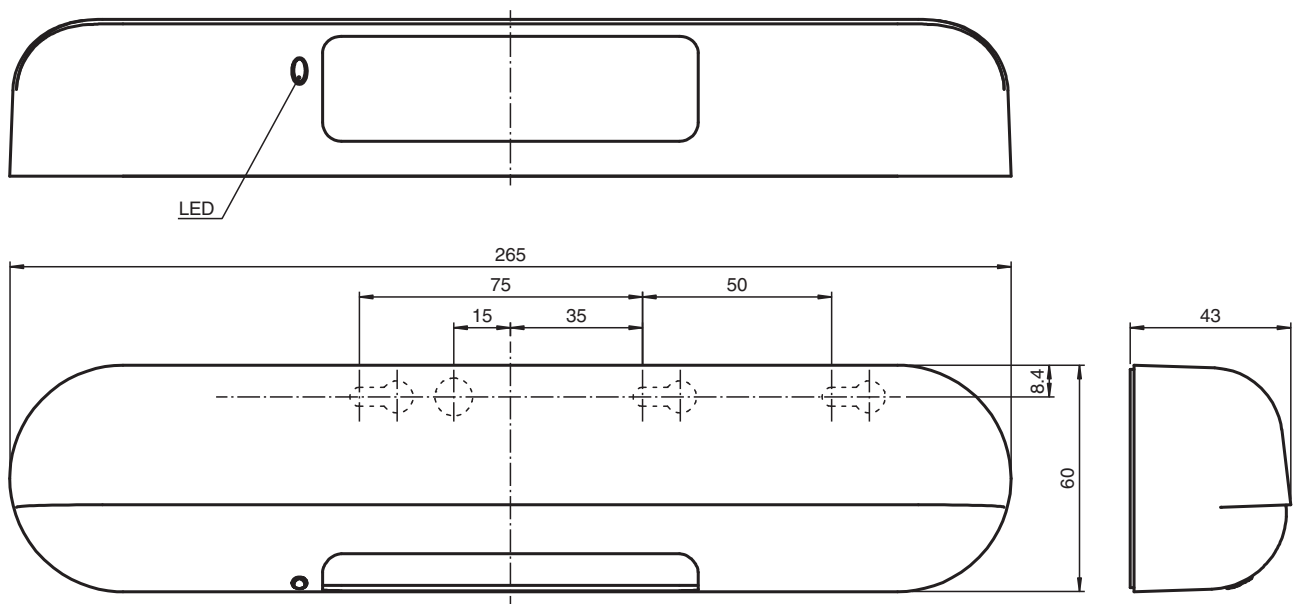

## Technical Data

### General specifications

Detection field	AIR, adjustable , total field: 2400 mm x 1000 mm (WxD) for a mounting height of 2200 mm
Detection field	Radar sensor 2500 mm x 4000 mm (d x w) at installation height of 2200 mm and 45° angle
Detection range max.	0 ... 3200 mm

Release date: 2023-03-28 Date of issue: 2023-03-28 Filename: 285849\_eng.pdf

## Technical Data

Light source		3 Series
Light type		modulated infrared light
Setting angle		-8 ... 4 °
Operating frequency		24.15 ... 24.25 GHz K-Band , Radar sensor
Transmitter radiated power (EIRP)		< 20 dBm
<b>Functional safety related parameters</b>		
Performance level (PL)		PL d
Category		Cat. 2
MTTF <sub>d</sub>		339.83 a
Diagnostic Coverage (DC)		81.52 %
<b>Indicators/operating means</b>		
Function indicator		LED green/blue/red/orange
Control elements		DIP switch
Control elements		sensitivity adjustment
Parameterization indicator		LED flashes when in adjustment mode Fast orange
<b>Electrical specifications</b>		
Operating voltage	U <sub>B</sub>	12 ... 24 V DC / 12 ... 24 V AC +/- 10%, 50 - 60 Hz
No-load supply current	I <sub>0</sub>	≤ 80 mA at 24 V DC ≤ 150 mA at 12 V:
Power consumption	P <sub>0</sub>	2.5 VA
<b>Input</b>		
Activation current		at 24 V DC 6 mA
Test input		active with +U <sub>B</sub>
<b>Output 1</b>		
Output type		Infrared, optocoupler
Switching voltage		48 V DC
Switching current		300 mA resistive load
De-energized delay		0.5 s
Switching type		light/dark on selectable programmable
Response time		100 ms up to 200 ms
<b>Output 2</b>		
Output type		Radar, relay
Switching voltage		48 V DC
Switching current		100 mA resistive load
De-energized delay		1.5 s
Switching type		NO/NC programmable
Response time		100 ms up to 200 ms
<b>Conformity</b>		
Functional safety		ISO 13849-1
Product standard		EN 12978
<b>Approvals and certificates</b>		
CE conformity		2014/53/EU This device can be used in all countries within the European Union. In other countries, all applicable national regulations must be observed.
FCC approval		No - Use in North America is not permitted.
CCC approval		CCC approval / marking not required for products rated ≤36 V
<b>Ambient conditions</b>		
Operating temperature		-20 ... 60 °C (-4 ... 140 °F)
Storage temperature		-20 ... 60 °C (-4 ... 140 °F)
Relative humidity		max. 80 %
<b>Mechanical specifications</b>		
Mounting height		max. 3200 mm
Degree of protection		IP54 (when mounted)
Connection		plug 8-pin , Connecting cable included with delivery
Material		

**Technical Data**

Housing	ABS
Mass	approx. 260 g
Dimensions	(W x H x D) 265 mm 60 mm 43 mm
Note	Please refer to the package insert for information on how to mount and install the sensor correctly.
<b>General information</b>	
Scope of delivery	sensor , cable , 2 screws , Mounting aid , Instruction leaflet
<b>Suitable series</b>	
Series	MotionScan

**Connection Assignment**

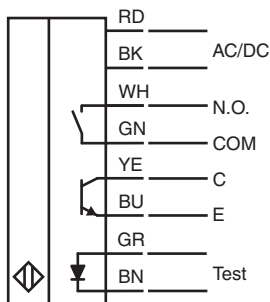

**Assembly**

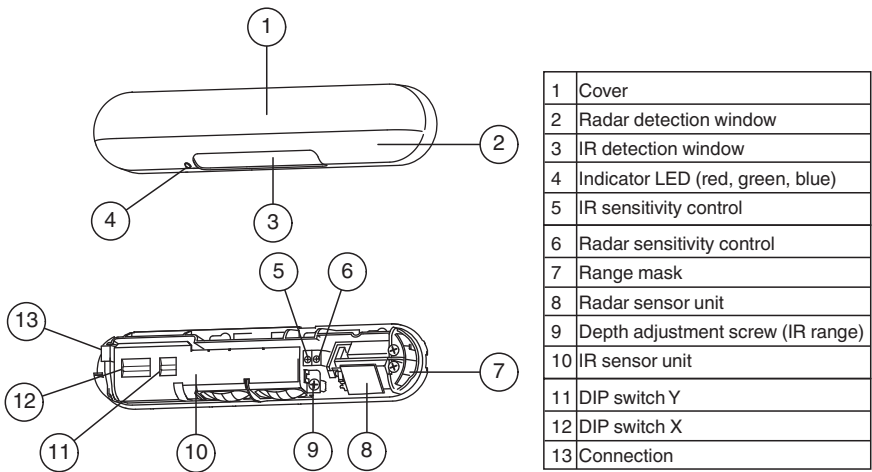

Release date: 2023-03-28 Date of issue: 2023-03-28 Filename: 285849\_eng.pdf

## Characteristic Curve

IR:

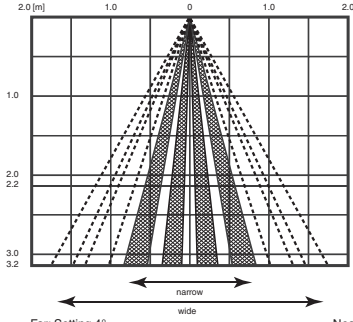

Far: Setting 4°

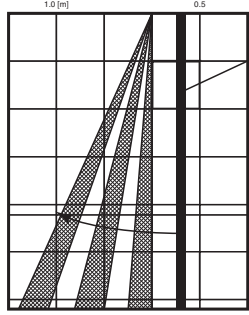

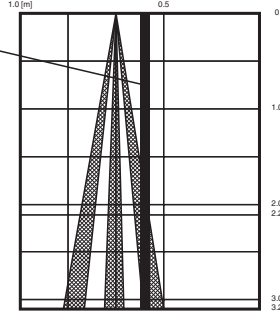

Near: Setting -8°

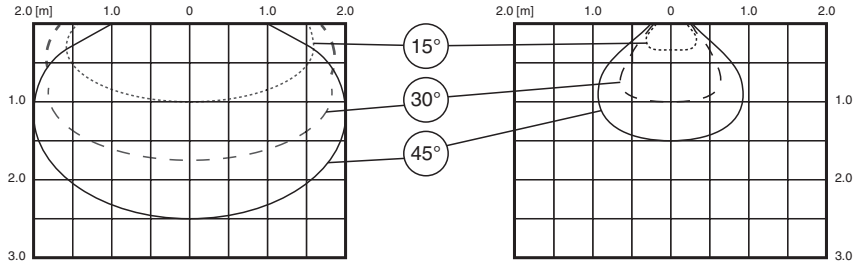

Radar:



## Accessories

	<b>MotionScan Intern. Mounting</b>	Ceiling mount kit
	<b>MotionScan Mount. Bracket</b>	Mounting bracket
	<b>MotionScan Weather Cap</b>	Weather cover

Release date: 2023-03-28 Date of issue: 2023-03-28 Filename: 285849\_eng.pdf

## Application

- Two-in-one sensor for opening and securing automatic sliding doors