



## LED Contact Module Ex e, 1 Pole, Base-mounted

### CFP.IL.SP

- Contact block 1x NO
- Component for appropriately certified Ex e enclosures
- Mounting on enclosure base
- DIN rail mountable
- Ex de certified
- Polyamide



## Connection

For complete wiring diagram see combination of actuator head and contact module.

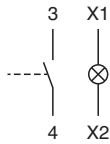

## Dimensions

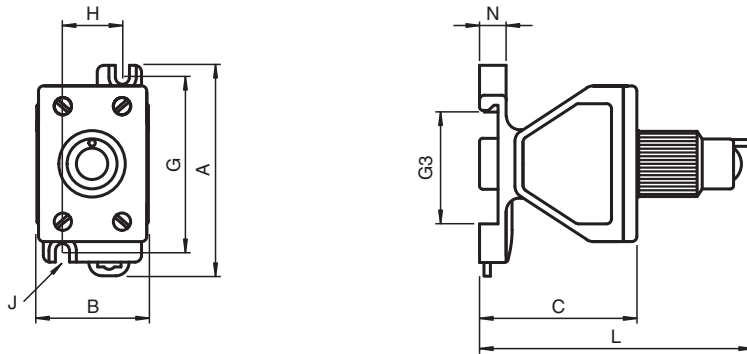

Dimension values see data table.  
Image and drawing are generic for this device type and may deviate from the specific variant.

## Technical Data

### Electrical specifications

Operating voltage	28 V max. AC/DC
Operating current	10 A max.
Power consumption	1 W

## Technical Data

Terminal capacity	2.5 mm <sup>2</sup>
Terminal torque	0.8 Nm
Function	Illuminated pushbutton module
Contact configuration	1x NO
Usage category	AC15: 10 ... 28 V AC - 10 A DC13: 10 ... 28 V DC - 1 A
Number of poles	1
<b>Mechanical specifications</b>	
Degree of protection	IP20
Material	
Housing	Polyamide (PA)
Mass	72 g
Mechanical life	300000 switching operations
Dimensions	
External dimension (A)	63 mm
External dimension (B)	33.4 mm
External dimension (C)	47 mm
Mounting holes distance (G)	52 mm
DIN mounting rail receptacle (G3)	35.6 mm
Mounting holes distance (H)	18 mm
Mounting holes diameter (J)	4.2 mm
Thickness of mounting brackets (N)	8 mm
Total length (L)	82 mm
Mounting	base-mounted DIN rail mounting
<b>Ambient conditions</b>	
Service temperature	-55 ... 90 °C (-67 ... 194 °F)
<b>Data for application in connection with hazardous areas</b>	
EU-type examination certificate	CML 19 ATEX 1178U
Marking	Ⓜ II 2 G Ex db eb IIC Gb
<b>International approvals</b>	
IECEX approval	IECEX CML 19.0054U
<b>Conformity</b>	
Degree of protection	EN 60529
Usage category	IEC / EN 60947
<b>General information</b>	
Supplementary information	EC-Type Examination Certificate, Statement of Conformity, Declaration of Conformity, Attestation of Conformity and instructions have to be observed where applicable. For information see <a href="http://www.pepperl-fuchs.com">www.pepperl-fuchs.com</a> .
Enclosure type	LR* GR.CS*