



## LED Contact Module Ex ia, 1 Pole, Base-mounted

### CFP.II.SP

- Contact block 1x NO
- Component for appropriately certified Ex e enclosures
- Mounting on enclosure base
- DIN rail mountable
- Ex ia certified
- Polyamide



## Connection

For complete wiring diagram see combination of actuator head and contact module.

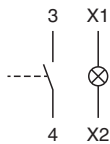

## Dimensions

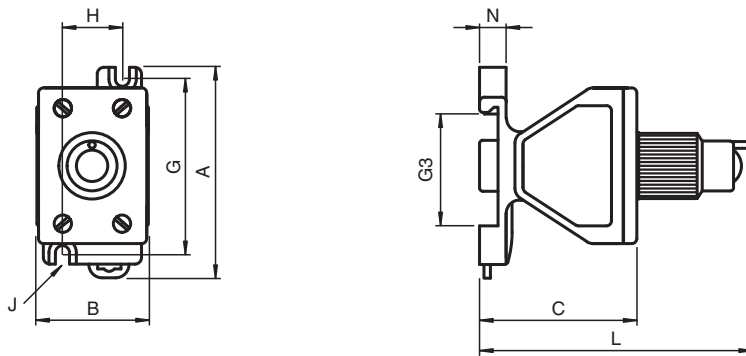

Dimension values see data table.  
Image and drawing are generic for this device type and may deviate from the specific variant.

## Technical Data

### Electrical specifications

Operating voltage	28 V max. AC/DC
Operating current	10 A max.
Power consumption	1 W

## Technical Data

Terminal capacity		2.5 mm <sup>2</sup>
Terminal torque		0.8 Nm
Function		Illuminated pushbutton module
Contact configuration		1x NO
Usage category		AC15: 10 ... 28 V AC - 93 mA DC13: 10 ... 28 V DC - 93 mA
Number of poles		1
<b>Mechanical specifications</b>		
Degree of protection		IP20
Material		
Housing		Polyamide (PA)
Mass		72 g
Mechanical life		300000 switching operations
Dimensions		
External dimension (A)		63 mm
External dimension (B)		33.4 mm
External dimension (C)		47 mm
Mounting holes distance (G)		52 mm
DIN mounting rail receptacle (G3)		35.6 mm
Mounting holes distance (H)		18 mm
Mounting holes diameter (J)		4.2 mm
Thickness of mounting brackets (N)		8 mm
Total length (L)		82 mm
Mounting		base-mounted DIN rail mounting
<b>Ambient conditions</b>		
Service temperature		-55 ... 90 °C (-67 ... 194 °F)
<b>Data for application in connection with hazardous areas</b>		
EU-type examination certificate		CML 19 ATEX 1178U
Marking		Ⓜ II 1 G Ex ia IIC Ga
Equipment		
Voltage	U <sub>i</sub>	LED 28 V switch 30 V
Current	I <sub>i</sub>	LED 93 mA switch 100 mA
Power	P <sub>i</sub>	LED 0.651 W switch 1 W
Internal capacitance	C <sub>i</sub>	LED 0.01 μF switch 0 μF
Internal inductance	L <sub>i</sub>	LED 2.2 mH switch 0 mH
<b>International approvals</b>		
IECEx approval		IECEx CML 19.0054U
<b>Conformity</b>		
Degree of protection		EN 60529
Usage category		IEC / EN 60947
<b>General information</b>		
Supplementary information		EC-Type Examination Certificate, Statement of Conformity, Declaration of Conformity, Attestation of Conformity and instructions have to be observed where applicable. For information see <a href="http://www.pepperl-fuchs.com">www.pepperl-fuchs.com</a> .
Enclosure type		LR* GR.CS*