



LED Contact Module Ex e, 1 Pole, Base-mounted

CFP.JL.SP

- Contact block 1x NC
- Component for appropriately certified Ex e enclosures
- Mounting on enclosure base
- DIN rail mountable
- Ex de certified
- Polyamide



Connection

For complete wiring diagram see combination of actuator head and contact module.

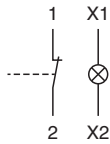

Dimensions

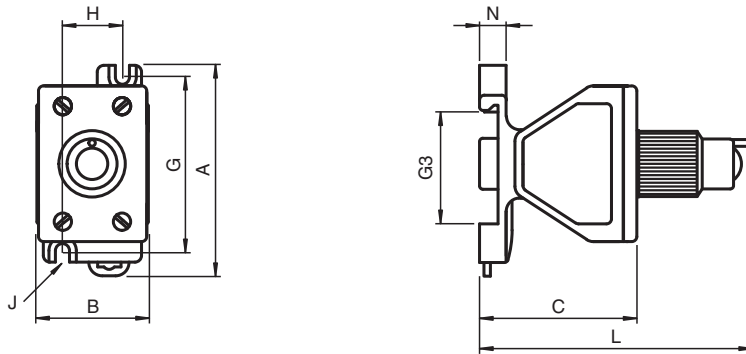

Dimension values see data table.
Image and drawing are generic for this device type and may deviate from the specific variant.

Technical Data

Electrical specifications

Operating voltage	28 V max. AC/DC
Operating current	10 A max.
Power consumption	1 W

Technical Data

Terminal capacity	2.5 mm ²
Terminal torque	0.8 Nm
Function	Illuminated pushbutton module
Contact configuration	1x NC
Usage category	AC15: 10 ... 28 V AC - 10 A DC13: 10 ... 28 V DC - 1 A
Number of poles	1
Mechanical specifications	
Degree of protection	IP20
Material	
Housing	Polyamide (PA)
Mass	72 g
Mechanical life	300000 switching operations
Dimensions	
External dimension (A)	63 mm
External dimension (B)	33.4 mm
External dimension (C)	47 mm
Mounting holes distance (G)	52 mm
DIN mounting rail receptacle (G3)	35.6 mm
Mounting holes distance (H)	18 mm
Mounting holes diameter (J)	4.2 mm
Thickness of mounting brackets (N)	8 mm
Total length (L)	82 mm
Mounting	base-mounted DIN rail mounting
Ambient conditions	
Service temperature	-55 ... 90 °C (-67 ... 194 °F)
Data for application in connection with hazardous areas	
EU-type examination certificate	CML 19 ATEX 1178U
Marking	⊕ II 2 G Ex db eb IIC Gb
International approvals	
IECEx approval	IECEx CML 19.0054U
Conformity	
Degree of protection	EN 60529
Usage category	IEC / EN 60947
General information	
Supplementary information	EC-Type Examination Certificate, Statement of Conformity, Declaration of Conformity, Attestation of Conformity and instructions have to be observed where applicable. For information see www.pepperl-fuchs.com .
Enclosure type	LR* GR.CS*