



LED Module Ex e and Ex i, Base-mounted

CFP.NI.SP

- 10 ... 28 V AC/DC
- Component for appropriately certified Ex e enclosures
- Mounting on enclosure base
- DIN rail mountable
- Ex de and Ex ia certified
- Polyamide



Dimensions

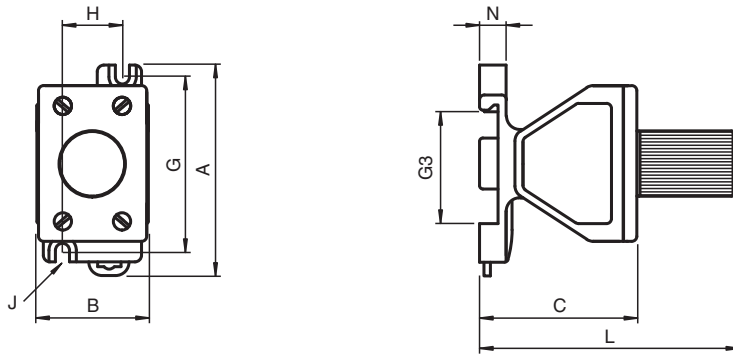

Dimension values see data table.
Image and drawing are generic for this device type and may deviate from the specific variant.

Technical Data

Electrical specifications

Operating voltage	28 V max. AC/DC
Power consumption	1 W max.
Terminal capacity	2.5 mm ²
Terminal torque	0.8 Nm
Function	LED module
Rated operating voltage	10 ... 28 V AC/DC , Ex ia

Mechanical specifications

Degree of protection	IP20
Material	
Housing	Polyamide (PA)
Mass	61 g
Dimensions	
External dimension (A)	63 mm
External dimension (B)	33.4 mm

Release date: 2025-06-12 Date of issue: 2025-06-14 Filename: 290227_eng.pdf

Technical Data

External dimension (C)	47 mm	
Mounting holes distance (G)	52 mm	
DIN mounting rail receptacle (G3)	35.6 mm	
Mounting holes distance (H)	18 mm	
Mounting holes diameter (J)	4.2 mm	
Thickness of mounting brackets (N)	8 mm	
Total length (L)	84 mm	
Mounting	base-mounted DIN rail mounting	
Ambient conditions		
Service temperature	-40 ... 90 °C (-40 ... 194 °F)	
Data for application in connection with hazardous areas		
EU-type examination certificate	CML 16 ATEX 3339U	
Marking	Ⓢ II 2 G Ex de IIC Gb Ⓢ II 1 G Ex ia IIC Ga	
Equipment		
Voltage	U _i	28 V
Current	I _i	93 mA
Power	P _i	0.651 W
Internal capacitance	C _i	0 µF
Internal inductance	L _i	0 mH
International approvals		
IECEx approval	IECEx CML 16.0114U	
Conformity		
Degree of protection	EN 60529	
General information		
Supplementary information	EC-Type Examination Certificate, Statement of Conformity, Declaration of Conformity, Attestation of Conformity and instructions have to be observed where applicable. For information see www.pepperl-fuchs.com .	
Enclosure type	LR* GR.CS*	