



## Adapter

### AD.NPT1.M40.BN.X.15.K35

- Adapter male thread NPT to female thread metric
- Brass nickel-plated
- Thread NPT 1"
- Thread M40
- Ex db, Ex eb and Ex tb certified
- Suitable for operation in Zone 1, Zone 2, Zone 21 and Zone 22
- Packaging unit: 35 pieces, without accessories



## Dimensions



Release date: 2024-07-17 Date of issue: 2024-07-17 Filename: 400911\_eng.pdf

Dimensions

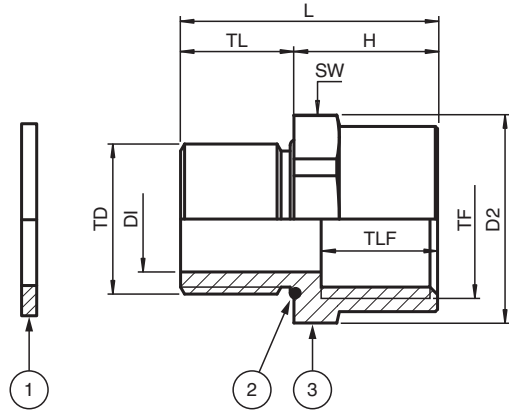

Details see data table

| Legend |  |
|--------|--|
| 1      | Washer gasket (accessory, metric threads only) |
| 2      | O-Ring (metric threads only)                   |
| 3      | Adapter  |
| DI     | Diameter internal hole                         |
| D2     | Width across corners                           |
| H      | Length outside enclosure                       |
| L      | Total length                                   |
| SW*    | Width across flats                             |
| TD     | Thread size                                    |
| TF     | Thread size female                             |
| TL     | Thread length                                  |
| TLF    | Thread length female                           |

Technical Data

| Mechanical specifications    |                               |
|------------------------------|-------------------------------|
| Thread type                  | NPT ANSI ASME B1.20.1         |
| Thread size (TD)             | NPT 1"                        |
| Thread type female           | metric ISO pitch 1.5 mm       |
| Thread size female (TF)      | M40                           |
| Degree of protection         | IP66 / IP68                   |
| Material                     |                               |
| Finish                       | inherent color silver         |
| Washer gasket                | aramid fibers bonded with NBR |
| Adapter                      | brass, nickel-plated          |
| Mass                         |                               |
| Individual component         | approx. 103 g                 |
| Packing unit                 | approx. 3.97 kg               |
| Dimensions                   |                               |
| Width across corners (D2)    | 50 mm                         |
| Diameter internal hole (DI)  | 26 mm                         |
| Length outside enclosure (H) | 22 mm                         |
| Width across flats (SW1)     | 45 mm                         |
| Thread length (TL)           | 15 mm                         |

Release date: 2024-07-17 Date of issue: 2024-07-17 Filename: 400911\_eng.pdf

## Technical Data

|  |  |
|--|--|
| Thread length female (TLF)                                     | 18 mm  |
| Total length (L)   | 37 mm  |
| Tightening torque  |  |
| Nut torque at enclosure (SW1)                                  | 11 Nm  |
| <b>Ambient conditions</b>                                      |  |
| Ambient temperature  | -60 ... 130 °C (-76 ... 266 °F)<br>washer gasket -40 ... 80 °C (-40 ... 176 °F)  |
| <b>Data for application in connection with hazardous areas</b> |  |
| EU-type examination certificate                                | CESI 15 ATEX 029X  |
| Marking  | Ⓜ II 2 GD<br>Ex db IIC Gb<br>Ex eb IIC Gb<br>Ex tb IIIC Db   |
| <b>International approvals</b>                                 |  |
| IECEx approval   | IECEx CES 15.0006X   |
| UKCA approval  | CML 22 UKEX 1267X  |
| CCoE approval  | PESO A/P/HQ/KA/104/5579 (P420366)  |
| CCC approval   | 2021312313000345   |
| <b>Conformity</b>  |  |
| Degree of protection   | EN 60529   |
| <b>General information</b>                                     |  |
| Delivery quantity  | 35   |
| Scope of delivery  | Adapter<br>Brief instructions (1 copy)   |
| Supplementary information                                      | EC-Type Examination Certificate, Statement of Conformity, Declaration of Conformity, Attestation of Conformity and instructions have to be observed where applicable. For information see <a href="http://www.pepperl-fuchs.com">www.pepperl-fuchs.com</a> . |