

Safety control unit

AOS 3230-W

- Safety control unit
- Safety category 3 according to EN61496-1
- Power/function indicator LEDs
- Signaling contacts with wiper function
- one OSE input
- force-guided safety relay
- For evaluating the LOW-POWER SIGNAL safety thru-beam sensor

Safety control unit



Dimensions

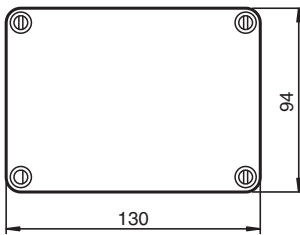
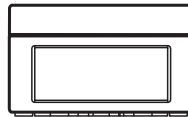
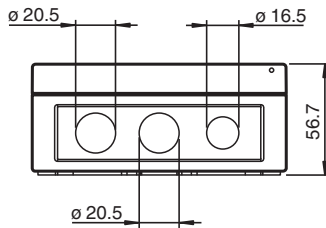
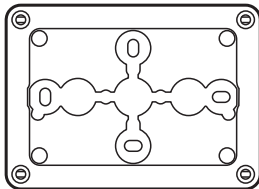

Technical Data

General specifications

Marking CE

Indicators/operating means

Operation indicator LED green: power on
 Function indicator LED yellow: safety loop has been interrupted
 LED green: Safety loop closed

Electrical specifications

Operating voltage U_B 230 V AC \pm 10 %
 Power consumption P_0 max. 6 VA

Output

Release date: 2024-07-02 Date of issue: 2024-07-08 Filename: 64319247_eng.pdf

Technical Data

Output type	relay, NO contact
Switching voltage	250 V AC / 50 V DC
Switching current	max. 1.25 A
Energized/De-energized delay	typ. 500 ms
Response time	≤ 20 ms
Output 1	
Output type	Signal output change-over contact
Switching voltage	250 V AC / 50 V DC
Switching current	max. 1.25 A
Response time	< 20 ms
Conformity	
Functional safety	ISO 13849-1 , Cat. 3 PL d
Product standard	EN 61000-6-2, EN 61000-6-3
Ambient conditions	
Ambient temperature	5 ... 55 °C (41 ... 131 °F)
Storage temperature	-25 ... 65 °C (-13 ... 149 °F)
Mechanical specifications	
Degree of protection	IP66 according to EN 60529
Connection	screw terminals , lead cross section 2 x 1 mm ²
Material	
Housing	Polycarbonate
Mass	590 g
Dimensions	
Height	95 mm
Width	130 mm
Depth	57 mm