

# Inductive slot sensor SC2-N0-Y106564

■ 2 mm slot width

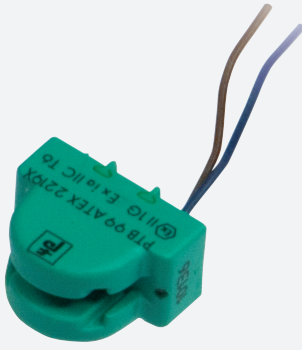

## Dimensions

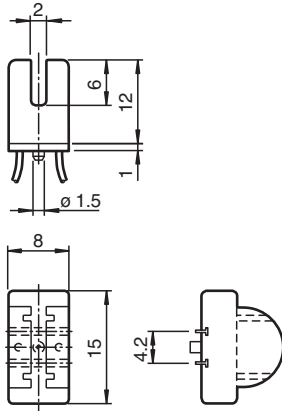

## Technical Data

### General specifications

Switching function	Normally closed (NC)
Output type	NAMUR
Slot width	2 mm
Depth of immersion (lateral)	5 ... 7 typ. 6 mm
Output type	2-wire

### Nominal ratings

Nominal voltage	$U_o$	8.2 V ( $R_i$ approx. 1 k $\Omega$ )
Operating voltage	$U_B$	5 ... 25 V
Switching frequency	f	0 ... 5000 Hz
Hysteresis	H	0 ... 0.05 mm
Reverse polarity protection		reverse polarity protected
Suitable for 2:1 technology		yes , Reverse polarity protection diode not required
Current consumption		
Measuring plate not detected		$\geq 3$ mA at nominal voltage
Measuring plate detected		$\leq 1$ mA at nominal voltage

### Functional safety related parameters

MTTF <sub>d</sub>	5270 a
Mission Time ( $T_M$ )	20 a

Release date: 2025-06-13 Date of issue: 2025-06-18 Filename: 70132955\_eng.pdf

## Technical Data

Diagnostic Coverage (DC)	0 %
<b>Compliance with standards and directives</b>	
Standard conformity	
NAMUR	EN 60947-5-6:2000 IEC 60947-5-6:1999
Standards	EN IEC 60947-5-2
<b>Approvals and certificates</b>	
IECEX approval	
Equipment protection level Ga	IECEX PTB 11.0091X
Equipment protection level Gb	IECEX PTB 11.0091X
Equipment protection level Da	IECEX PTB 11.0091X
Equipment protection level Mb	IECEX PTB 11.0091X
ATEX approval	
Equipment protection level Ga	PTB 99 ATEX 2219 X
Equipment protection level Gb	PTB 99 ATEX 2219 X
Equipment protection level Da	PTB 99 ATEX 2219 X
UL approval	
Ordinary Location	cULus Listed, General Purpose E87056
Hazardous Location	E501628
Control drawing	116-0453
CCC approval	
Hazardous Location	2020322315002306
NEPSI approval	
NEPSI certificate	GYJ16.1391X
<b>Ambient conditions</b>	
Ambient temperature	-25 ... 100 °C (-13 ... 212 °F)
<b>Mechanical specifications</b>	
Connection type	flexible leads
Housing material	PBT
Degree of protection	IP67
Cable	
Cable diameter	0.75 mm ± 0.15 mm
Bending radius	> 10 x cable diameter
Material	PVC
Core cross section	0.06 mm <sup>2</sup>
Length	L 500 mm
Dimensions	
Height	13 mm
Width	15 mm
Length	8 mm
<b>General information</b>	
Use in the hazardous area	see instruction manuals

## Connection Assignment

