

Inductive slot sensor SC2-N0-YE



- 2 mm slot width
- Usable up to SIL 2 acc. to IEC 61508



Dimensions

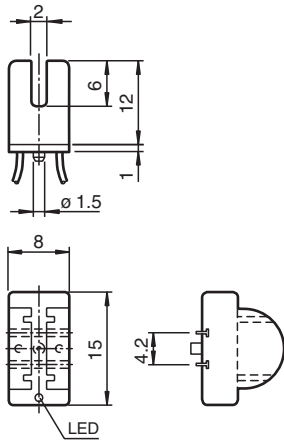

Technical Data

General specifications	
Switching function	Normally closed (NC)
Output type	NAMUR
Slot width	2 mm
Depth of immersion (lateral)	5 ... 7 typ. 6 mm
Output type	2-wire
Nominal ratings	
Nominal voltage	U_o 8.2 V (R_i approx. 1 k Ω)
Operating voltage	U_B 5 ... 25 V
Switching frequency	f 0 ... 5000 Hz
Hysteresis	H 0 ... 0.05 mm
Current consumption	
Measuring plate not detected	min. 3 mA
Measuring plate detected	\leq 1 mA
Switching state indicator	LED, yellow
Functional safety related parameters	
Safety Integrity Level (SIL)	SIL 2

Release date: 2025-06-13 Date of issue: 2025-06-18 Filename: 70132957_eng.pdf

Technical Data

Compliance with standards and directives

Standard conformity		
NAMUR		EN 60947-5-6:2000 IEC 60947-5-6:1999
Electromagnetic compatibility		NE 21:2007
Standards		EN IEC 60947-5-2

Approvals and certificates

IECEX approval		
Equipment protection level Ga		IECEX PTB 11.0091X
Equipment protection level Gb		IECEX PTB 11.0091X
Equipment protection level Da		IECEX PTB 11.0091X
Equipment protection level Mb		IECEX PTB 11.0091X
ATEX approval		
Equipment protection level Ga		PTB 99 ATEX 2219 X
Equipment protection level Gb		PTB 99 ATEX 2219 X
Equipment protection level Da		PTB 99 ATEX 2219 X
UL approval		
Ordinary Location		cULus Listed, General Purpose E87056
Hazardous Location		E501628
Control drawing		116-0453
CCC approval		
Hazardous Location		2020322315002306
NEPSI approval		
NEPSI certificate		GYJ16.1391X
Marine approval		DNVGL TAA00001A5

Ambient conditions

Ambient temperature		-25 ... 100 °C (-13 ... 212 °F)
---------------------	--	---------------------------------

Mechanical specifications

Connection type		flexible leads
Housing material		PBT
Degree of protection		IP67
Cable		
Cable diameter		0.75 mm ± 0.15 mm
Bending radius		> 10 x cable diameter
Material		PVC
Core cross section		0.06 mm ²
Length	L	500 mm
Dimensions		
Height		13 mm
Width		15 mm
Length		8 mm

General information

Use in the hazardous area		see instruction manuals
---------------------------	--	-------------------------

Connection Assignment

