

Inductive slot sensor SC3,5-N0-Y106570

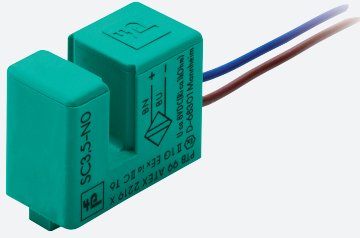

Dimensions

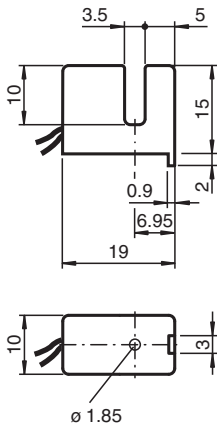

Technical Data

General specifications			
Switching function			Normally closed (NC)
Output type			NAMUR
Slot width			3.5 mm
Depth of immersion (lateral)			5 ... 7 typ. 6 mm
Output type			2-wire
Nominal ratings			
Nominal voltage	U_o		8.2 V (R_i approx. 1 k Ω)
Operating voltage	U_B		5 ... 25 V
Switching frequency	f		0 ... 3000 Hz
Hysteresis	H		0 ... 0.05 mm
Suitable for 2:1 technology			yes , Reverse polarity protection diode not required
Current consumption			
Measuring plate not detected			≥ 3 mA at nominal voltage
Measuring plate detected			≤ 1 mA at nominal voltage
Functional safety related parameters			
MTTF _d			5290 a
Mission Time (T_M)			20 a

Release date: 2025-07-14 Date of issue: 2025-07-14 Filename: 70132965_eng.pdf

Technical Data

Diagnostic Coverage (DC)		0 %
Compliance with standards and directives		
Standard conformity		
NAMUR		EN 60947-5-6:2000 IEC 60947-5-6:1999
Standards		EN IEC 60947-5-2
Approvals and certificates		
IECEX approval		
Equipment protection level Ga		IECEX PTB 11.0091X
Equipment protection level Gb		IECEX PTB 11.0091X
Equipment protection level Da		IECEX PTB 11.0091X
Equipment protection level Mb		IECEX PTB 11.0091X
ATEX approval		
Equipment protection level Ga		PTB 99 ATEX 2219 X
Equipment protection level Gb		PTB 99 ATEX 2219 X
Equipment protection level Da		PTB 99 ATEX 2219 X
UL approval		
		cULus Listed Load Type: General Purpose Circuitry: Class 2 Power Source Enclosure Type Rating: Type 1 Supply/Switching Voltage: 8.2 V DC
Ordinary Location		E87056
Hazardous Location		E501628
Control drawing		116-0453
Ambient conditions		
Ambient temperature		-25 ... 100 °C (-13 ... 212 °F)
Mechanical specifications		
Connection type		flexible leads
Housing material		PBT
Degree of protection		IP67
Cable		
Cable diameter		1.1 mm ± 0.1 mm
Bending radius		> 10 x cable diameter
Material		PVC
Core cross section		0.14 mm ²
Length	L	500 mm
Dimensions		
Height		15 mm
Width		10 mm
Length		19.5 mm
General information		
Use in the hazardous area		see instruction manuals

Connection Assignment

