

Inductive slot sensor

SJ10-N

- 10 mm slot width
- Usable up to SIL 2 acc. to IEC 61508



Dimensions

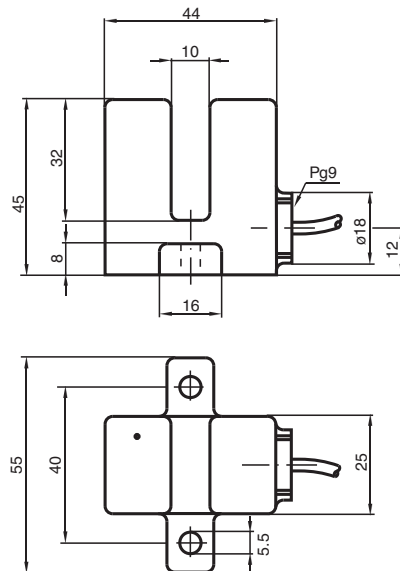

Technical Data

General specifications

Switching function	Normally closed (NC)
Output type	NAMUR
Slot width	10 mm
Depth of immersion (lateral)	13.5 ... 16.5 mm , typ. 15 mm
Output type	2-wire

Nominal ratings

Nominal voltage	U_o	8.2 V (R_i approx. 1 k Ω)
Operating voltage	U_B	5 ... 25 V
Switching frequency	f	0 ... 1000 Hz
Hysteresis	H	0.1 ... 0.5 mm

Current consumption

Measuring plate not detected	≥ 3 mA at nominal voltage
Measuring plate detected	≤ 1 mA at nominal voltage

Technical Data

Functional safety related parameters		
Safety Integrity Level (SIL)		SIL 2
MTTF _d		11460 a
Mission Time (T _M)		20 a
Diagnostic Coverage (DC)		0 %
Compliance with standards and directives		
Standard conformity		
NAMUR		EN 60947-5-6:2000 IEC 60947-5-6:1999
Standards		EN IEC 60947-5-2
Approvals and certificates		
IECEX approval		
Equipment protection level Ga		IECEX PTB 11.0091X
Equipment protection level Gb		IECEX PTB 11.0091X
Equipment protection level Da		IECEX PTB 11.0091X
Equipment protection level Mb		IECEX PTB 11.0091X
ATEX approval		
Equipment protection level Ga		PTB 99 ATEX 2219 X
Equipment protection level Gb		PTB 99 ATEX 2219 X
Equipment protection level Da		PTB 99 ATEX 2219 X
UL approval		
Ordinary Location		E87056
Hazardous Location		E501628
Control drawing		116-0453
CCC approval		
Hazardous Location		2020322315002306
NEPSI approval		
NEPSI certificate		GYJ16.1391X
KCC approval		
Hazardous Location		13-AV4BO-0353X
Marine approval		DNVGL TAA00001A5
Ambient conditions		
Ambient temperature		-25 ... 100 °C (-13 ... 212 °F)
Mechanical specifications		
Connection type		cable
Housing material		PBT
Degree of protection		IP67
Cable		
Cable diameter		6 mm ± 0.2 mm
Bending radius		> 10 x cable diameter
Material		PVC
Core cross section		0.75 mm ²
Length	L	2 m
Tightening torque, fastening screws		3 Nm
Dimensions		
Height		45 mm
Width		55 mm
Length		44 mm
General information		
Use in the hazardous area		see instruction manuals

Connection Assignment



Release date: 2025-06-13 Date of issue: 2025-06-18 Filename: 70132970_eng.pdf