

# Inductive slot sensor

## SJ3,5-H

- 3.5 mm slot width

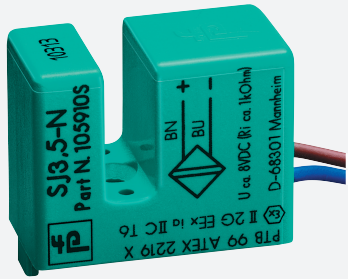

### Dimensions

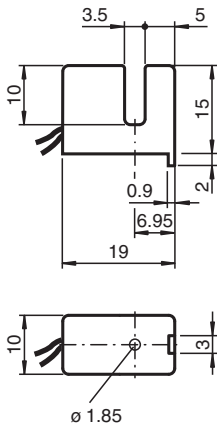

### Technical Data

#### General specifications

Switching function	Normally closed (NC)
Output type	NAMUR
Slot width	3.5 mm
Depth of immersion (lateral)	5 ... 7 mm , typ. 6 mm
Output type	2-wire

#### Nominal ratings

Nominal voltage	$U_o$	8.2 V ( $R_i$ approx. 1 k $\Omega$ )
Operating voltage	$U_B$	5 ... 25 V
Switching frequency	f	0 ... 3000 Hz
Hysteresis	H	0.8 ... 1.1 mm

#### Current consumption

Measuring plate not detected	$\geq 3$ mA at nominal voltage
Measuring plate detected	$\leq 1$ mA at nominal voltage

#### Functional safety related parameters

MTTF <sub>d</sub>	8760 a
Mission Time ( $T_M$ )	20 a
Diagnostic Coverage (DC)	0 %

Release date: 2024-05-27 Date of issue: 2024-05-31 Filename: 70132982\_eng.pdf

## Technical Data

Compliance with standards and directives		
Standard conformity		
NAMUR		EN 60947-5-6:2000
Standards		EN IEC 60947-5-2
Approvals and certificates		
IECEX approval		
Equipment protection level Gb		IECEX PTB 11.0091X
Equipment protection level Da		IECEX PTB 11.0091X
Equipment protection level Mb		IECEX PTB 11.0091X
ATEX approval		
Equipment protection level Gb		PTB 99 ATEX 2219 X
Equipment protection level Da		PTB 99 ATEX 2219 X
UL approval		cULus Listed, General Purpose
Ambient conditions		
Ambient temperature		-25 ... 70 °C (-13 ... 158 °F)
Mechanical specifications		
Connection type		flexible leads
Housing material		PBT
Degree of protection		IP67
Cable		
Cable diameter		1.1 mm ± 0.1 mm
Bending radius		> 10 x cable diameter
Material		PVC
Core cross section		0.14 mm <sup>2</sup>
Length	L	500 mm
Dimensions		
Height		15 mm
Width		10 mm
Length		19.5 mm
General information		
Use in the hazardous area		see instruction manuals

## Connection

