

Inductive slot sensor SJ3,5-H-Y17012

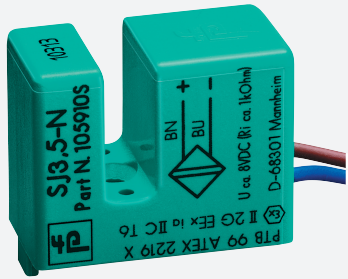

■ Comfort series



Dimensions

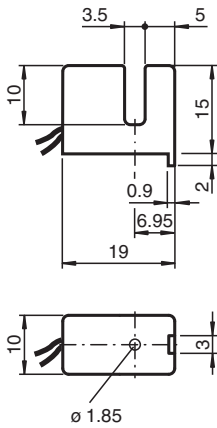

Technical Data

General specifications

Switching function	Normally closed (NC)
Output type	NAMUR
Slot width	3.5 mm
Depth of immersion (lateral)	5 ... 7 typ. 6 mm
Output type	2-wire

Nominal ratings

Nominal voltage	U_o	8.2 V (R_i approx. 1 k Ω)
Operating voltage	U_B	5 ... 25 V
Switching frequency	f	0 ... 3000 Hz
Hysteresis	H	0.8 ... 1.1 mm
Current consumption		
Measuring plate not detected		≥ 3 mA at nominal voltage
Measuring plate detected		≤ 1 mA at nominal voltage

Compliance with standards and directives

Standard conformity		
NAMUR		EN 60947-5-6:2000
Standards		EN IEC 60947-5-2

Release date: 2024-05-27 Date of issue: 2024-05-31 Filename: 70132983_eng.pdf

Technical Data

Approvals and certificates

IECEX approval

Equipment protection level Gb	IECEX PTB 11.0091X
Equipment protection level Da	IECEX PTB 11.0091X
Equipment protection level Mb	IECEX PTB 11.0091X

ATEX approval

Equipment protection level Gb	PTB 99 ATEX 2219 X
Equipment protection level Da	PTB 99 ATEX 2219 X

UL approval

cULus Listed, General Purpose

Ambient conditions

Ambient temperature	-25 ... 70 °C (-13 ... 158 °F)
---------------------	--------------------------------

Mechanical specifications

Connection type	flexible leads
Housing material	PBT
Degree of protection	IP67

Cable

Material	PTFE	
Core cross section	0.14 mm ²	
Length	L	500 mm

Dimensions

Height	15 mm
Width	10 mm
Length	19.5 mm

General information

Use in the hazardous area	see instruction manuals
---------------------------	-------------------------

Connection

