

Inductive sensor

NCN2-F56-N1-Y107584

■ 2 mm non-flush



Dimensions

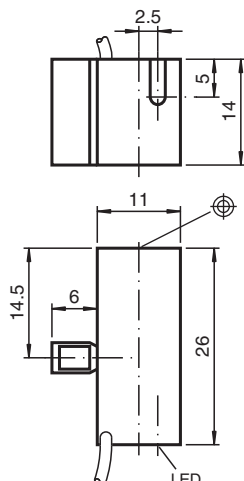

Technical Data

General specifications

Output type		NAMUR
Rated operating distance	s_n	2 mm
Installation		non-flush
Assured operating distance	s_a	0 ... 1.62 mm
Actual operating distance	s_r	1.8 ... 2.2 mm typ.
Reduction factor r_{Al}		0.5
Reduction factor r_{Cu}		0.45
Reduction factor r_{304}		0.8
Output type		2-wire

Nominal ratings

Nominal voltage	U_o	8.2 V (R_i approx. 1 k Ω)
Switching frequency	f	0 ... 300 Hz
Hysteresis	H	1 ... 10 % typ. 3 %
Reverse polarity protection		reverse polarity protected
Current consumption		
Measuring plate not detected		≤ 1 mA

Release date: 2024-12-10 Date of issue: 2024-12-10 Filename: 70133124_eng.pdf

Technical Data

Measuring plate detected	≥ 3 mA
Switching state indicator	LED, yellow
Compliance with standards and directives	
Standard conformity	
Standards	EN IEC 60947-5-2
Approvals and certificates	
IECEX approval	
Equipment protection level Gb	IECEX PTB 11.0021X
Equipment protection level Da	IECEX PTB 11.0021X
Equipment protection level Mb	IECEX PTB 11.0021X
ATEX approval	
Equipment protection level Gb	PTB 00 ATEX 2032 X
Equipment protection level Da	PTB 00 ATEX 2032 X
UL approval	cULus Listed, General Purpose
CML approval	on request
Ambient conditions	
Ambient temperature	-25 ... 85 °C (-13 ... 185 °F)
Mechanical specifications	
Connection type	cable
Housing material	PA 6 GF35 Grivory GVN-35H sw
Sensing face	PA 6 GF35 Grivory GVN-35H sw
Degree of protection	IP67
Cable	
Wire end ferrules	yes
Cable diameter	2.6 mm ± 0.2 mm
Bending radius	> 10 x cable diameter
Material	PVC
Color	blue
Number of cores	2
Core cross section	0.14 mm ²
Length	L 0.17 m
Dimensions	
Height	17 mm
Width	14 mm
Length	26 mm
General information	
Use in the hazardous area	see instruction manuals

Connection

