

# Inductive sensor

## NJ1,5-10GM-N-Y183937

■ 1 mm flush



### Dimensions

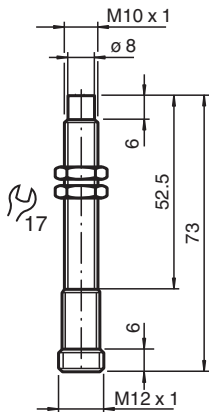

### Technical Data

#### General specifications

Switching function		Normally closed (NC)
Output type		NAMUR
Rated operating distance	$s_n$	1 mm
Installation		flush
Assured operating distance	$s_a$	0 ... 0.81 mm
Actual operating distance	$s_r$	0.9 ... 1.1 mm typ.
Reduction factor $r_{Al}$		0.4
Reduction factor $r_{Cu}$		0.3
Reduction factor $r_{304}$		0.85
Output type		2-wire

#### Nominal ratings

Nominal voltage	$U_o$	8.2 V ( $R_i$ approx. 1 k $\Omega$ )
Switching frequency	$f$	1.5 kHz
Hysteresis	$H$	1 ... 10 % typ. 5 %
Current consumption		
Measuring plate not detected		min. 3 mA
Measuring plate detected		$\leq$ 1 mA

#### Compliance with standards and directives

Standard conformity		
NAMUR		EN 60947-5-6:2000 IEC 60947-5-6:1999
Standards		EN IEC 60947-5-2

#### Approvals and certificates

Release date: 2024-12-11 Date of issue: 2024-12-11 Filename: 70133224\_eng.pdf

## Technical Data

<b>IECEX approval</b>		
Equipment protection level Gb		IECEX PTB 11.0037X
Equipment protection level Da		IECEX PTB 11.0037X
Equipment protection level Mb		IECEX PTB 11.0037X
<b>ATEX approval</b>		
Equipment protection level Gb		PTB 00 ATEX 2048 X
Equipment protection level Da		PTB 00 ATEX 2048 X
UL approval		cULus Listed, General Purpose
CML approval		on request
ANZEx		18.3018X
<b>Ambient conditions</b>		
Ambient temperature		-25 ... 100 °C (-13 ... 212 °F)
<b>Mechanical specifications</b>		
Connection type		Connector plug
Housing material		brass, nickel-plated
Sensing face		PBT
Degree of protection		IP67
Connector		
Threading		M12 x 1
Number of pins		4
Dimensions		
Length		72 mm
Diameter		8 mm
<b>General information</b>		
Use in the hazardous area		see instruction manuals

## Connection

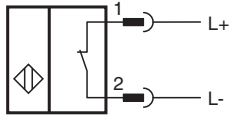

## Connection Assignment

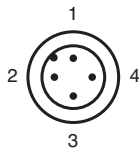

Wire colors in accordance with EN 60947-5-6

1		BN	(brown)
2		BU	(blue)