

# Inductive sensor

## NBN15-30GK60-UR-1M



- Relay output
- Sensing range 15 mm
- SPDT output
- AC/DC Model
- Switch load currents to 6 Amps



### Dimensions

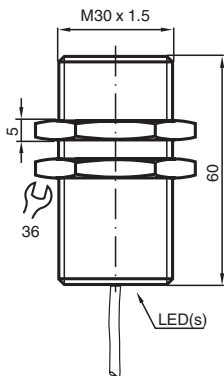

### Technical Data

General specifications		
Switching function		change-over contact
Output type		relay
Rated operating distance	$S_n$	15 mm
Installation		non-flush
Output polarity		DC
Reduction factor $r_{Al}$		0.4
Reduction factor $r_{Cu}$		0.37
Reduction factor $r_{304}$		0.73
Output type		Relay output
Mechanical life		No load: $2 \times 10^7$ operations Full load: $1 \times 10^5$ switching cycles
Nominal ratings		
Hysteresis	H	1 ... 12 % typ. 10 %
Reverse polarity protection		reverse polarity tolerant
Short-circuit protection		no
Rated operating current	$I_e$	< 50 mA AC/DC
Switching state indicator		LED, red 360°

Release date: 2024-10-17 Date of issue: 2024-10-17 Filename: 904971\_eng.pdf

## Technical Data

### Electrical specifications

Rated operating voltage	$U_e$	20 ... 132 V AC/DC
-------------------------	-------	--------------------

### Output

Switching voltage		max 28 V DC , 250 V AC
Switching current		6 A , AC/DC, resistive load
Switching power		max 180 W

### Compliance with standards and directives

Standard conformity		
Standards		EN IEC 60947-5-2

### Approvals and certificates

UL approval		cULus Listed, General Purpose
CSA approval		cCSAus Listed, General Purpose

### Ambient conditions

Ambient temperature		-40 ... 70 °C (-40 ... 158 °F)
---------------------	--	--------------------------------

### Mechanical specifications

Connection type		cable
Housing material		PBT
Sensing face		PBT
Degree of protection		IP68
Cable		
Wire end ferrules		yes
Cable diameter		7.6 mm ± 0.25 mm
Bending radius		> 10 x cable diameter
Material		PVC
Color		black
Number of cores		5
Core cross section		0.75 mm <sup>2</sup>
Length	L	1 m
Dimensions		
Length		60 mm
Diameter		30 mm

## Connection

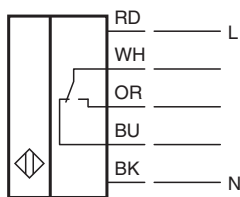

Release date: 2024-10-17 Date of issue: 2024-10-17 Filename: 904971\_eng.pdf