

Inductive sensor

NMB10-18GM55-E2



- 10 mm flush
- Stainless steel sensing face
- Increased operating distance



Dimensions

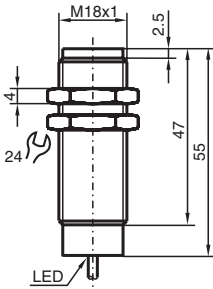

Technical Data

| General specifications | | |
|-----------------------------|-------|---|
| Switching function | | Normally open (NO) |
| Output type | | PNP |
| Rated operating distance | s_n | 10 mm |
| Installation | | flush (Requirements: see drawing below) |
| Output polarity | | DC |
| Assured operating distance | s_a | 0 ... 8.1 mm |
| Actuating element | | Ferrous and nonferrous targets |
| Reduction factor r_{Al} | | 0.4 |
| Reduction factor r_{Cu} | | 0.25 |
| Reduction factor r_{304} | | 0.85 |
| Reduction factor r_{St37} | | 1 |
| Output type | | 3-wire |
| Nominal ratings | | |
| Operating voltage | U_B | 10 ... 30 V DC |
| Switching frequency | f | 0 ... 240 Hz |
| Hysteresis | H | 3 ... 15 typ. 10 % |

Release date: 2025-06-06 Date of issue: 2025-06-06 Filename: 911281_eng.pdf

Technical Data

| | | |
|---|-------|---|
| Reverse polarity protection | | reverse polarity protected |
| Short-circuit protection | | pulsing |
| Voltage drop | U_d | $\leq 2 \text{ V}$ |
| Operating current | I_L | $\leq 200 \text{ mA}$ |
| Off-state current | I_r | $10 \mu\text{A}$ |
| No-load supply current | I_0 | $\leq 10 \text{ mA}$ |
| Operating voltage indicator | | LED, green |
| Switching state indicator | | LED, yellow |
| Functional safety related parameters | | |
| MTTF _d | | 847 a |
| Mission Time (T _M) | | 20 a |
| Diagnostic Coverage (DC) | | 0 % |
| Compliance with standards and directives | | |
| Standard conformity | | |
| Standards | | EN IEC 60947-5-2 |
| Approvals and certificates | | |
| UL approval | | cULus Listed Load Type: General Purpose Circuitry: Class 2 Power Source Enclosure Type Rating: Type 1 Supply/Switching Voltage: 30 V DC Output Switching Current: 200 mA |
| CCC approval | | CCC approval / marking not required for products rated $\leq 36 \text{ V}$ |
| Ambient conditions | | |
| Ambient temperature | | -25 ... 70 °C (-13 ... 158 °F) |
| Mechanical specifications | | |
| Connection type | | cable |
| Housing material | | Stainless steel 1.4305 / AISI 303 |
| Sensing face | | Stainless steel 1.4305 / AISI 303 |
| Degree of protection | | IP69K |
| Cable | | |
| Wire end ferrules | | yes |
| Cable diameter | | 6.2 mm \pm 0.2 mm |
| Bending radius | | > 10 x cable diameter |
| Material | | PUR |
| Color | | black |
| Number of cores | | 3 |
| Core cross section | | 0.5 mm ² |
| Length | L | 2 m |
| Dimensions | | |
| Length | | 55 mm |
| Diameter | | 18 mm |

Connection Assignment

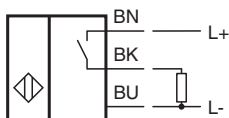

Mounting

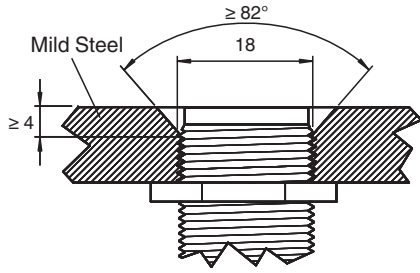

Sensor face is flush with mounting surface.