

# Stopping Plugs, Metal, Hexagon Socket Head

SP.MA.\*.\*.\*

- Stopping plug for unused cable entries
- Brass nickel-plated or stainless steel
- NPT versions available
- Without head, installation by means of allen key
- Ex db, Ex eb and Ex tb certified
- Suitable for operation in Zone 1, Zone 2, Zone 21 and Zone 22
- Suitable for operation in Class I, Zone 1/2/22
- Suitable for operation in Class I, Division 2 when installed in accordance with NEC501.10(B)(2)
- Degree of protection IP66 / IP68, UL Type 4X



## Function

The metal stopping plugs type SP.MA.\* are suitable for safely closing openings and holes for cable entries that are not used in enclosures certified according to type of protection Ex eb or Ex tb as well as for Ex db. They are available with NPT thread and feature a hexagon socket without head for installation by means of allen key.

## Technical Data

### Mechanical specifications

Thread type	NPT ANSI ASME B1.20.1
Thread size (TD)	see data table
Degree of protection	IP66 / IP68 , UL Type 4X
Material	
Finish	inherent color silver
Stopping plug	brass nickel-plated or AISI 316 (1.4401) stainless steel
Mass	see data table
Dimensions	see data table

### Ambient conditions

Ambient temperature	-60 ... 130 °C (-76 ... 266 °F)
---------------------	---------------------------------

### Data for application in connection with hazardous areas

EU-type examination certificate	CESI 15 ATEX 029X
Marking	⊕ II 2 GD Ex db IIC Gb Ex eb IIC Gb Ex tb IIIC Db

### International approvals

UL approval	
cULus	E305142 tested to UL 50E and UL 508A CSA C22.2, No. 14-13
IECEX approval	IECEX CES 15.0006X
UKCA approval	CML 22 UKEX 1267X
CCC approval	2021312313000343

### Conformity

Degree of protection	EN 60529
CE marking	0102

### General information

Release date: 2023-09-01 Date of issue: 2023-09-01 Filename: t182521\_eng.pdf

**Technical Data**

Scope of delivery	K01 - NPT variants, individual component: Stopping Plug , Brief instructions Knn - packing unit with multiple components: Stopping Plugs , Brief instructions (1 copy)
Supplementary information	EC-Type Examination Certificate, Statement of Conformity, Declaration of Conformity, Attestation of Conformity and instructions have to be observed where applicable. For information see www.pepperl-fuchs.com.

**Type Code**

<b>1</b>		<b>2</b>		<b>3</b>		<b>4</b>		<b>5</b>		<b>6</b>		<b>7</b>
SP	.	MA	.	***	.	**	.	*	.	**	.	K**
SP	.	MA	.	NPT1	.	BN	.	X	.	25	.	K01

Example: SP.MA.NPT1.BN.X.25.K01  
 Stopping plug, metal, without head, for installation by means of allen key, thread size NPT 1", body brass nickel-plated, without seal, installation thread length 25 mm, one piece

<b>1</b>	<b>Series</b>
SP	Stopping plug
<b>2</b>	<b>Type</b>
MA	metal, hexagon socket head
<b>3</b>	<b>Thread, type and size</b>
NPT*	NPT ANSI ASME B1.20.1; sizes see dimensions data table
<b>4</b>	<b>Material</b>
BN	brass nickel-plated
SS	stainless steel
<b>5</b>	<b>Material seals / O-Ring</b>
X	no seal
<b>6</b>	<b>Thread length for installation in enclosure</b>
**	length in mm
<b>7</b>	<b>Packaging unit</b>
	units not packaged, for use in Pepperl+Fuchs Solution Engineering Centers
K**	units quantity per package

Release date: 2023-09-01 Date of issue: 2023-09-01 Filename: t182521\_eng.pdf

## Dimensions

Legend	
1	Stopping plug
KS	Key size
L	Total length
TD	Thread size
TL	Thread length

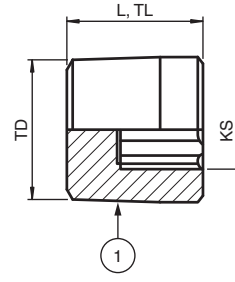

**Dimensions NPT - Brass Nickel-plated**

Type	Thread size	Dimensions [mm]			Mass approx.		Nut torques [Nm]	Delivery quantity
	TD	L	TL	KS	Component	Packaging unit	KS	
SP.MA.NPT3/8.BN.X.15.K01	NPT 3/8"	15	15	6	25 g	35 g	7	1
SP.MA.NPT3/8.BN.X.15.K50	NPT 3/8"	15	15	6	25 g	1.38 kg	7	50
SP.MA.NPT1/2.BN.X.20.K01	NPT 1/2"	20	20	10	42 g	52 g	8	1
SP.MA.NPT1/2.BN.X.20.K50	NPT 1/2"	20	20	10	42 g	2.31 kg	8	50
SP.MA.NPT3/4.BN.X.20.K01	NPT 3/4"	20	20	10	81 g	91 g	9	1
SP.MA.NPT3/4.BN.X.20.K50	NPT 3/4"	20	20	10	81 g	4.46 kg	9	50
SP.MA.NPT1.BN.X.25.K01	NPT 1"	25	25	14	157 g	167 g	11	1
SP.MA.NPT1.BN.X.25.K25	NPT 1"	25	25	14	157 g	4.32 kg	11	25
SP.MA.NPT1-1/4.BN.X.25.K01	NPT 1-1/4"	25	25	14	236 g	246 g	13	1
SP.MA.NPT1-1/4.BN.X.25.K10	NPT 1-1/4"	25	25	14	236 g	2.6 kg	13	10
SP.MA.NPT1-1/2.BN.X.25.K01	NPT 1-1/2"	25	25	14	298 g	308 g	15	1
SP.MA.NPT1-1/2.BN.X.25.K05	NPT 1-1/2"	25	25	14	298 g	1.64 kg	15	5
SP.MA.NPT2.BN.X.25.K01	NPT 2"	25	25	14	479 g	489 g	18	1
SP.MA.NPT2.BN.X.25.K05	NPT 2"	25	25	14	479 g	2.63 kg	18	5

\*Knn: scope of delivery see table technical data

**Dimensions NPT - Stainless Steel**

Type	Thread size	Dimensions [mm]			Mass approx.		Nut torques [Nm]	Delivery quantity
	TD	L	TL	KS	Component	Packaging unit	KS	
SP.MA.NPT3/8.SS.X.15.K01	NPT 3/8"	15	15	6	24 g	34 g	7	1
SP.MA.NPT3/8.SS.X.15.K50	NPT 3/8"	15	15	6	24 g	1.32 kg	7	50
SP.MA.NPT1/2.SS.X.20.K01	NPT 1/2"	20	20	10	46 g	56 g	8	1
SP.MA.NPT1/2.SS.X.20.K50	NPT 1/2"	20	20	10	46 g	2.53 kg	8	50
SP.MA.NPT3/4.SS.X.20.K01	NPT 3/4"	20	20	10	77 g	87 g	9	1
SP.MA.NPT3/4.SS.X.20.K50	NPT 3/4"	20	20	10	77 g	4.24 kg	9	50
SP.MA.NPT1.SS.X.25.K01	NPT 1"	25	25	14	149 g	159 g	11	1
SP.MA.NPT1.SS.X.25.K25	NPT 1"	25	25	14	149 g	4.1 kg	11	25
SP.MA.NPT1-1/4.SS.X.25.K01	NPT 1-1/4"	25	25	14	224 g	225 g	13	1
SP.MA.NPT1-1/4.SS.X.25.K10	NPT 1-1/4"	25	25	14	224 g	2.46 kg	13	10
SP.MA.NPT1-1/2.SS.X.25.K01	NPT 1-1/2"	25	25	14	283 g	293 g	15	1
SP.MA.NPT1-1/2.SS.X.25.K05	NPT 1-1/2"	25	25	14	283 g	1.56 kg	15	5
SP.MA.NPT2.SS.X.25.K01	NPT 2"	25	25	14	454 g	464 g	18	1
SP.MA.NPT2.SS.X.25.K05	NPT 2"	25	25	14	454 g	2.5 kg	18	5

\*Knn: scope of delivery see table technical data

Release date: 2023-09-01 Date of issue: 2023-09-01 Filename: t182521\_eng.pdf