

## Accessories for the F25 Series

Assembly kit	Shaft diameter <sup>1)</sup>	Shaft height	Mounting hole configuration	Consisting of:		Fig.
				Actuating element	Bracket	
BT32-F25-0	< 34 mm	20 mm	(30 x 80) mm	BT32	–	1
BT33-F25-0	< 34 mm	30 mm	(30 x 80) mm	BT33	–	3
BT34-F25-2	preferably > 34 mm	20/30 mm	(30 x 80) mm	BT34	K2	2
BT34-F25-3	preferably > 34 mm	30 mm	(30 x 130) mm	BT34	K3	4
BT34-F25-4	preferably > 34 mm	50 mm	(30 x 130) mm	BT34	K4	5
MH5-F25-Y43089	< 34 mm	20/30 mm	(30 x 130) mm	–	Metal plate	6
MH20-F25-Y43090	Height adjustment for additionally mounted controller			–	F25 fully potted	7

<sup>1)</sup> If the ring is higher than 3 mm, the circlip height is critical rather than the shaft diameter.

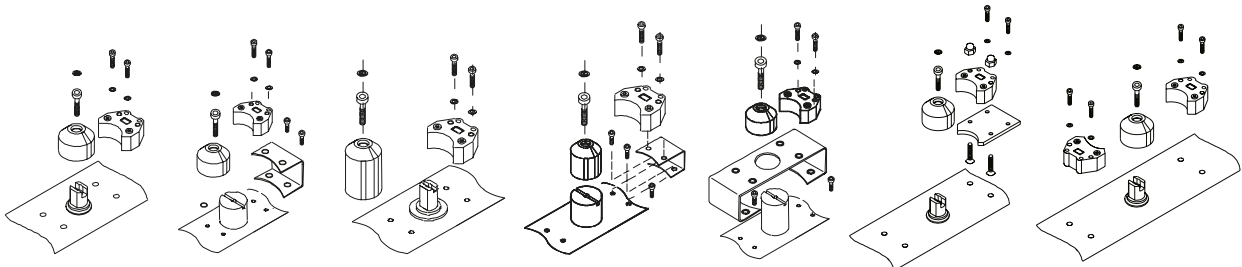

Component	Shaft diameter	Mounting hole configuration	Comments	Fig.
<b>Actuating element</b>				
BT32	34 mm	–	Height of active surface: 28 mm	8
BT33	34 mm	–	Height of active surface: 38 mm	9
BT34	34 mm	–	Height of active surface: 28 mm, mounted on shaft	10
BT37	34 mm	–	Actuating element BT37 with 4 mm groove for mounting controller	–
<b>Bracket</b>				
K2	–	(30 x 80) mm	–	2
K3	–	(30 x 130) mm	–	4
K4	–	(30 x 130) mm	–	5

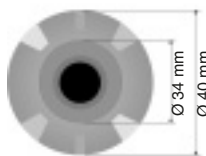

Fig. 8

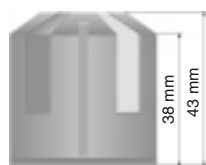

Fig. 9

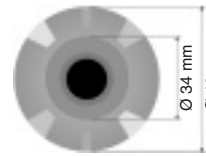

Fig. 10